



Portland's Creative Industrial Community

Courtesy to brokers

- 8'-FT LED lighting fixtures throughout.
- Water supply stubbed into space.
- Natural gas available.
- Double door entry suitable for forklift access.
- Easy access to exterior loading.
- Fully sprinklered.
- Concrete floor and ceiling.
- Approx. 9' clear ceiling.
- Bottom of truss is 12'-6" clear of the floor



Unit G05 Available Now

\$8.40 NNN | NNN average \$3.96/SF/YR

inquiries@generalindustry.com

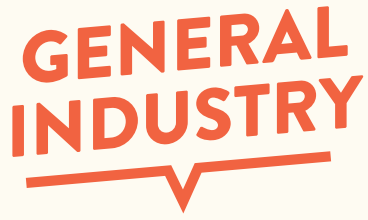

UNIT G05

5,360SF

AVAILABLE FOR LEASE

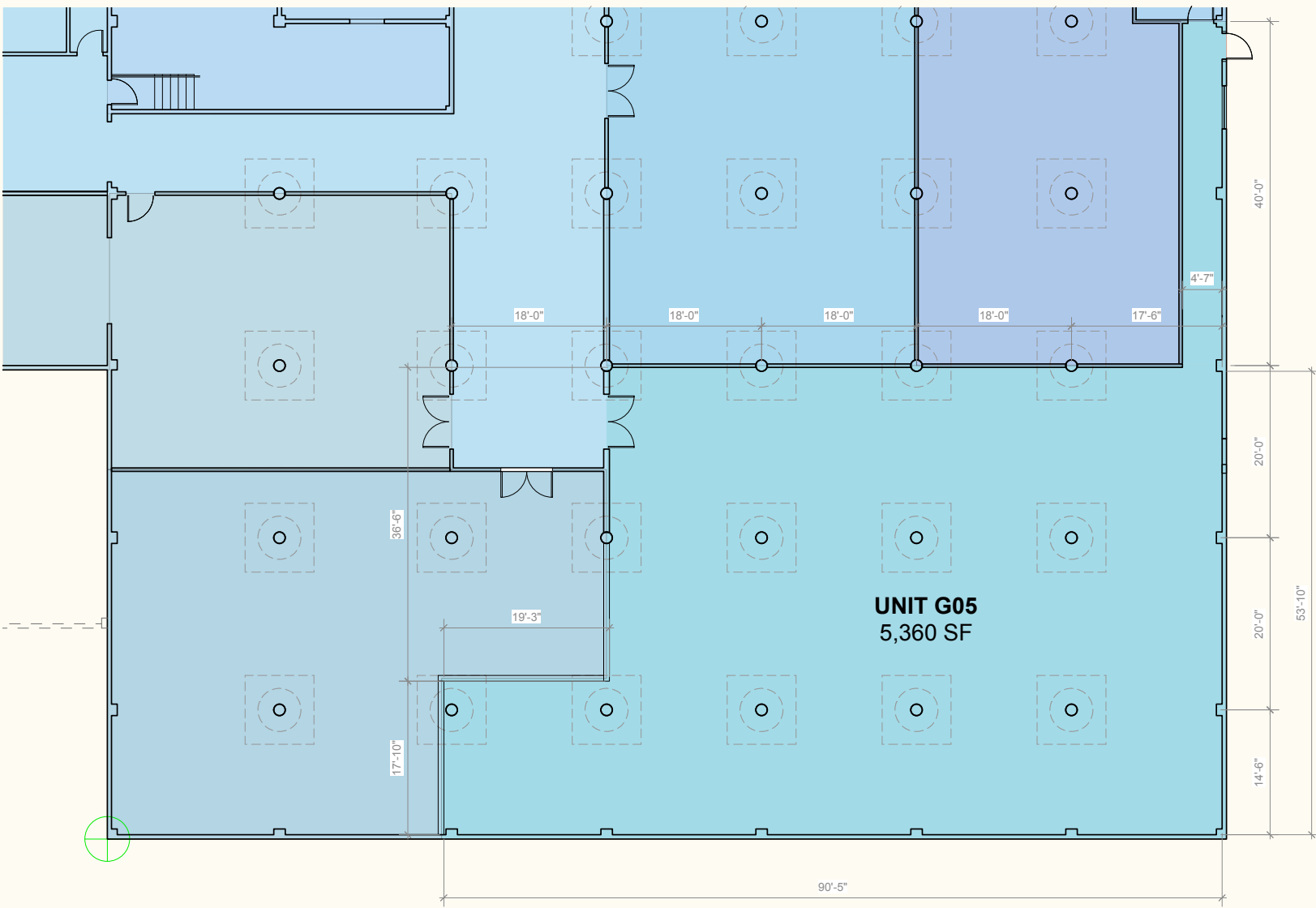

© 2023 GENERAL INDUSTRY. SUBJECT TO CHANGE WITHOUT NOTICE

Unit G05 Available Now

\$8.40 NNN | NNN average \$3.96/SF/YR

inquiries@generalindustry.com